

Smart Photoelectric Smoke Sensor User Manual

M11-001-1

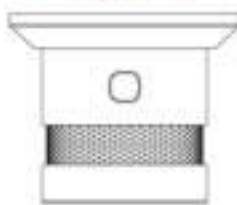

*Please read the user manual carefully before operation.
The guide picture is for reference only. Please in kind print.

This product is a smart photoelectric smoke sensor, with ultra-low-power ZigBee wireless network technology design. It is capable of real-time detecting the presence of smoke, once detect danger at fire smoke, red LED flashes rapidly and detectors sound alarm once detecting smoke fire danger, can alert you and your family timely. It can be widely used in household, lounge, coffee house, dancing hall, any other places need fire alarm monitoring. Free tool installation, once stick once use.



Smart Photoelectric Smoke Sensor

1. Operating Voltage: DC5V (CR123A lithium battery)
2. Static Current: $\leq 15\mu\text{A}$
3. Alarm Current: $\leq 10\text{mA}$
4. Alarm Indication: Red LED
5. Sound Level: $80\text{dB}/3\text{m}$
6. Networking Way: ZigBee Ad-Hoc Networking
7. Distance Of Ad-Hoc Network: $\geq 70\text{m}$ (open area)
8. Working Temperature: $-10^{\circ}\text{C} \sim +50^{\circ}\text{C}$
9. Working Humidity: $\leq 90\%/\text{RH}$
10. Dimension: $60 \times 60 \times 49.2\text{mm}$

- **Flat ceiling mounting**
The preferred location to install smoke sensor is in the centre of the ceiling, because smoke, heat and combustible products rise to ceiling and will laterally spread. Keep at least 30cm distance from lights or decorations, and at least 15 cm away from walls and corners.

- **Sloping ceiling mounting**
If ceiling is sloping, please install the smoke sensor at horizontal distance 90cm away from the ceiling top.



Recommended and Avoided Installation Position



Sloping Ceiling Mounting Position

- Please put smart hub into the center of alarm.
- Please shorten the distance between smart hub and alarm.
- Please remove barriers between smart hub and alarm.
- Avoid installing in places with high noise area or high frequency interference, like places near from metal air conditioner, heater device, current circuit breaker control line.
- Building materials with metal nail or metal bar may reduce the wireless transmission distance, like reinforced concrete wall.
- Carrying of the signal makes direct radio with barriers, if the materials of the barrier is homogeneous.



- Anticlockwise rotating the bracket out from the installation base.

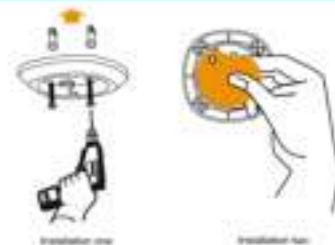

- Installation step: Tighten the bracket into ceiling using screws.
- Installation step: remove the double-sided adhesive and stick alarm into ceiling.



- Remove the battery (including step) to make detector on power and clockwise rotating alarm into bracket.



- Click "G" on the APP interface, and enter the networking mode. (Please take user manual of smart hub for reference)



- Adding network: according to APP prompt, press the button for 2 seconds after the networking equipment, green flash, APP interface prompted, networking success.
- Disconnect network: press the networking button for 3 seconds to disconnect the network, after the green light flashes slowly for 3 seconds, which indicates network is disconnected successfully.

LED State and Alarm

State	LED	Sound Alarm
Standby	red LED flash every 50 seconds	NO
Test	red LED flash quickly	rapid "Di-Di-Di"
Alarm	red LED flash quickly	rapid "Di-Di-Di"
Flash	red LED flash every 50 seconds	NO
Low Power	red LED flash one time	"Di" every 50 seconds
Fault	red LED flash twice every 50 seconds	"Di-Di" twice every 50 seconds

— Page 1 —

LED	State
Green LED	1. Rapidly flash during networking (3times/seconds) 2. Keep on for around 2 seconds if network success 3. Flash slowly if network failed, if network success 4. 100% operation, ZigBee network failed, flash slowly 3 times 5. Long press network button for 3 seconds, red LED on around 2 seconds then flash slowly for 3 times disconnect success.

FAQ

Phenomenon	Analysis	Treatment
Power on and alarm	There is large dust or water	power on after cleaning dust or water
Power on with about 2h "Di"	Low power	Change same battery
Buzzer do not alarm or great "Di-Di"	Low power	Change same battery
Press test button but no alarm	green control of battery or battery polarity wrong Low power Low power	insert battery and pay attention to battery polarity Change same battery Change same battery
Device off line	alarm device too far away from smart hub 1. Add receiver 2. Shorten distance between smart hub and smart device, press test button or power on again	
Networking failed	Alarm device not built from network gateway do not enter network state	Switch network that before networking Make sure gateway under networking state

Please make sure that there is no real danger of fire when using mute function. Under known and non-fire alarm condition, please do not block or by any other form to prohibit alarming. Press the Test/Mute button to lower sensitivity and relieve alarm.



Press and hold the last panel Test/Mute button for 3 seconds, as above picture shows, until alarm status (see status table). Testing is recommended to be done at least once a week. Do not use flame for testing. Once the alarm is sure to please pay attention.



- Please replace battery correctly, following the battery positive and negative electrode. Attention is environmental protection and dispose used battery properly.

1. Please press test button to test alarm devices weekly, after device put into use, please inspect the alarm device or return back factory if any faults happened (like buzzer do not make sound, LED do not turn on).
2. Battery can use around 3 years under normal condition, high temperature, high humidity or other poor condition may shorten battery life span.
3. Please change the same battery timely when receiving low power indication, press test button if alarm device make sound and flash alarm means change battery success.
4. Please install alarm device as soon as alarm device planning to be test, make sure alarm devices in good condition, and take measure for dust proof, damp proof and corrosion proof etc.
5. Do not dismantle alarm device privately if any problems of alarm device happened, please power off and contact local agent.
6. Suggest change new battery after real fire alarm happened.

Warning

1. Do not install alarm devices in places with high temperature, high humidity, heavy oil fume, and keep nearby environment clean.
2. Avoid install in places near from heavy oil paint, solvent or other solvent suspected solids, in case of any influence for normal detecting of alarm devices.
3. This product is household usage smart smoke alarm, which can make sound and flash alarm when fire happens, but can not put out a fire.

Remark

*The guide picture is for reference only. Please in kind print.
*Factory use final sign for explanation if there is any inconsistency between printed use and use instruction, as technology is improving from time to time.